



425











MARKET
SAN FRANCISCO, CA

AVAILABILITIES FROM 15,000 - 277,000 RSF



BUILDING HIGHLIGHTS



-  Leed platinum certified
-  Energy star rated
-  Institutional, long-term ownership
-  Large efficient floor plates
-  Barcha Restaurant
-  3 elevator banks with 6 cabs per bank
-  Convenient on-site parking
-  24-hour security
-  Easily accessible bike storage
-  On-site shower and locker room

AVAILABILITY SUMMARY

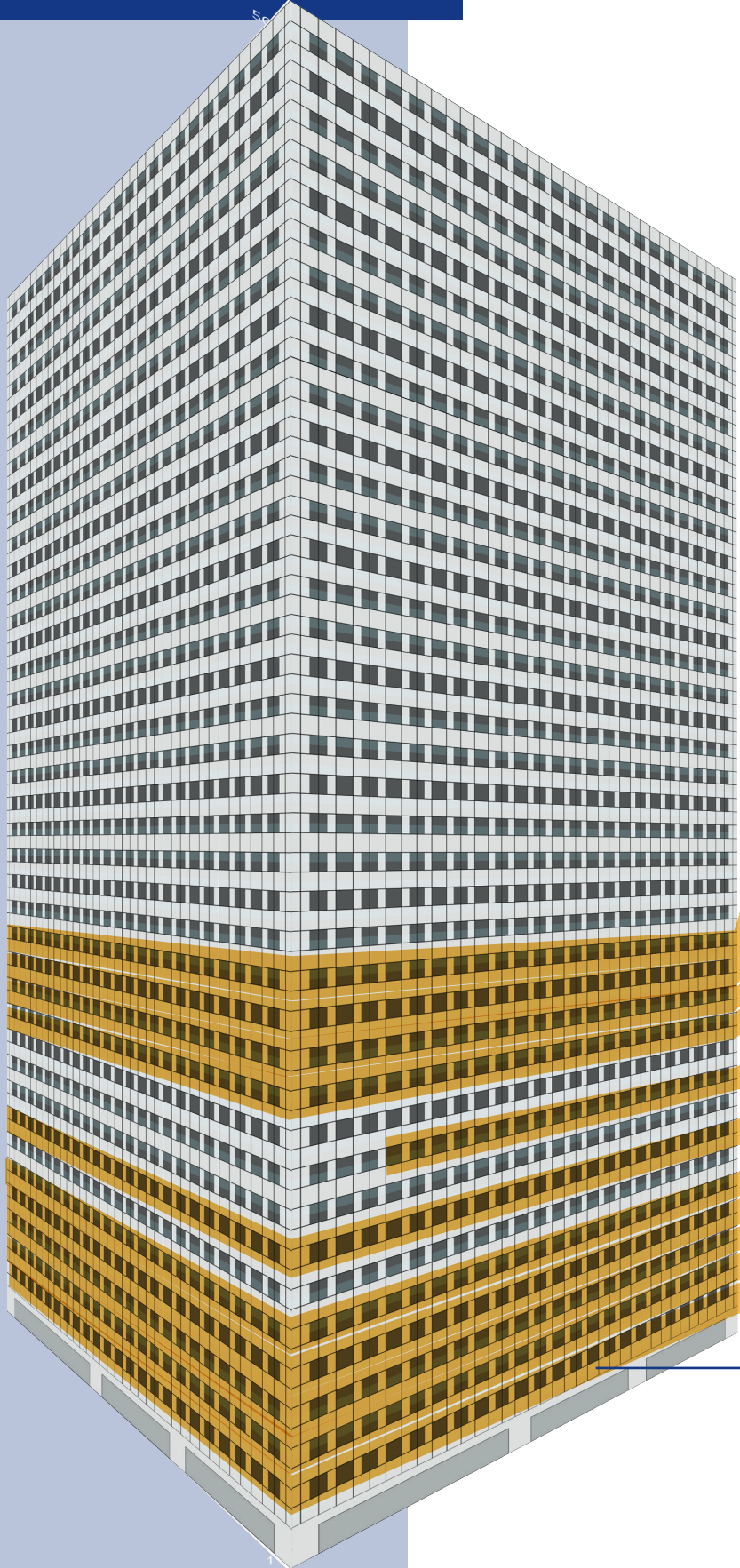

**FLOORS 12-15 ARE
CONTIGUOUS FOR ±104,000 SF**

15TH FLOOR | 26,158 RSF | 6/1/2023

14TH FLOOR | 26,159 RSF | 6/1/2023

13TH FLOOR | 25,158 RSF | 7/1/2024

12TH FLOOR | 26,859 RSF | 7/1/2024

10TH FLOOR | 14,662 RSF | 3/1/2024

8TH FLOOR | 26,870 RSF | 7/1/2024

6TH FLOOR | 26,862 RSF | 11/1/2023

5TH FLOOR | 26,172 RSF | 11/1/2023

4TH FLOOR | 26,171 RSF | 11/1/2023

3RD FLOOR | 26,173 RSF | 11/1/2023

2ND FLOOR | 25,750 RSF | 11/1/2023

**COVETED 2ND FLOOR
ASSEMBLY OPPORTUNITY**

**FLOORS 2 -6 ARE
CONTIGUOUS FOR ±130,000 SF**

2ND FLOOR: 25,750 RSF

HYPOTHETICAL COLLABORATION FOCUSED SPACE PLAN*

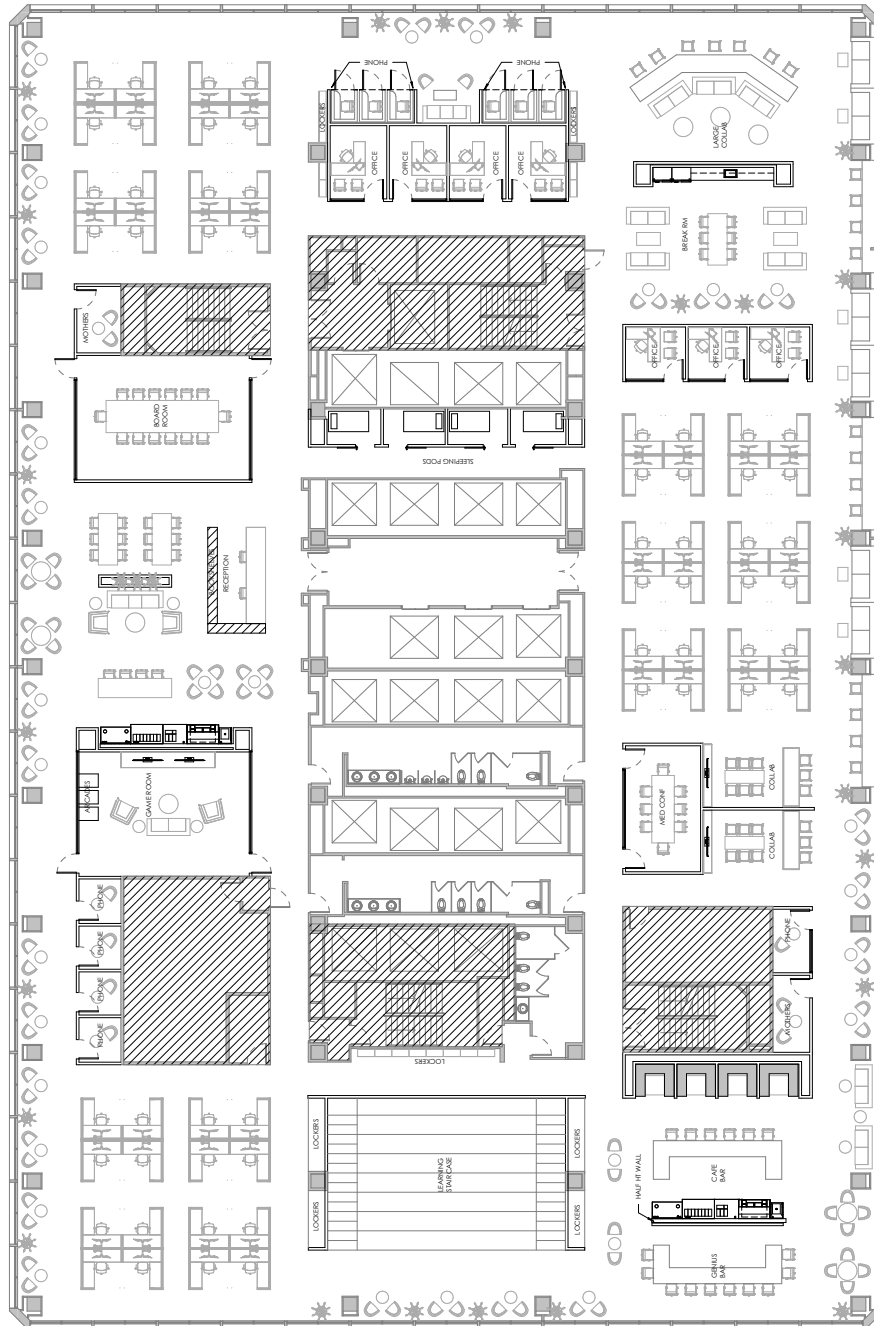

- RECEPTION
- (3) BREAK ROOM AREAS
- GAME ROOM
- LEARNING STAIR
- (1) BOARD ROOM
- (2) MOTHERS ROOMS
- (1) CONF ROOMS
- (7) OFFICES
- (11) PHONE ROOMS
- (56) WORKSTATIONS
- (4) SLEEPING PODS

*ASSEMBLY CODE COMPLIANT
SEPARATE SHUTTLE ELEVATOR TO FLOOR

TYPICAL LOW-RISE FLOOR

HYPOTHETICAL OFFICE INTENSIVE SPACE PLAN

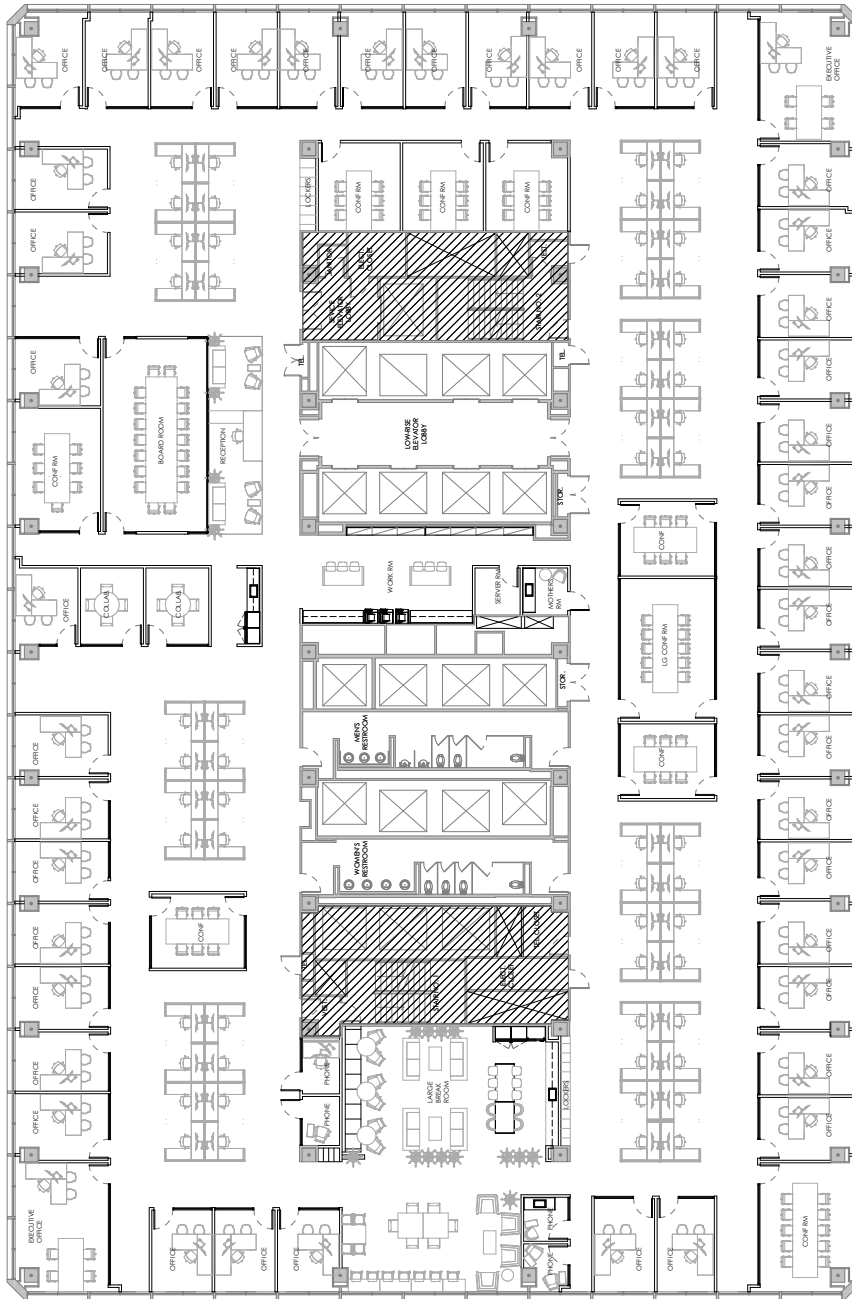

- ± 27,000 RSF
- RECEPTION
- BOARD ROOM
- (10) CONFERENCE ROOMS
- (4) PHONE BOOTH
- (2) EXECUTIVE OFFICES
- (43) OFFICES
- (56) WORKSTATIONS
- LARGE BREAK ROOM / CAFE
- LARGE RESTROOMS
- (2) MOTHER'S ROOMS
- SERVER ROOM
- LARGE WORK ROOM

TYPICAL LOW-RISE FLOOR

HYPOTHETICAL OPEN/TECH SPACE PLAN

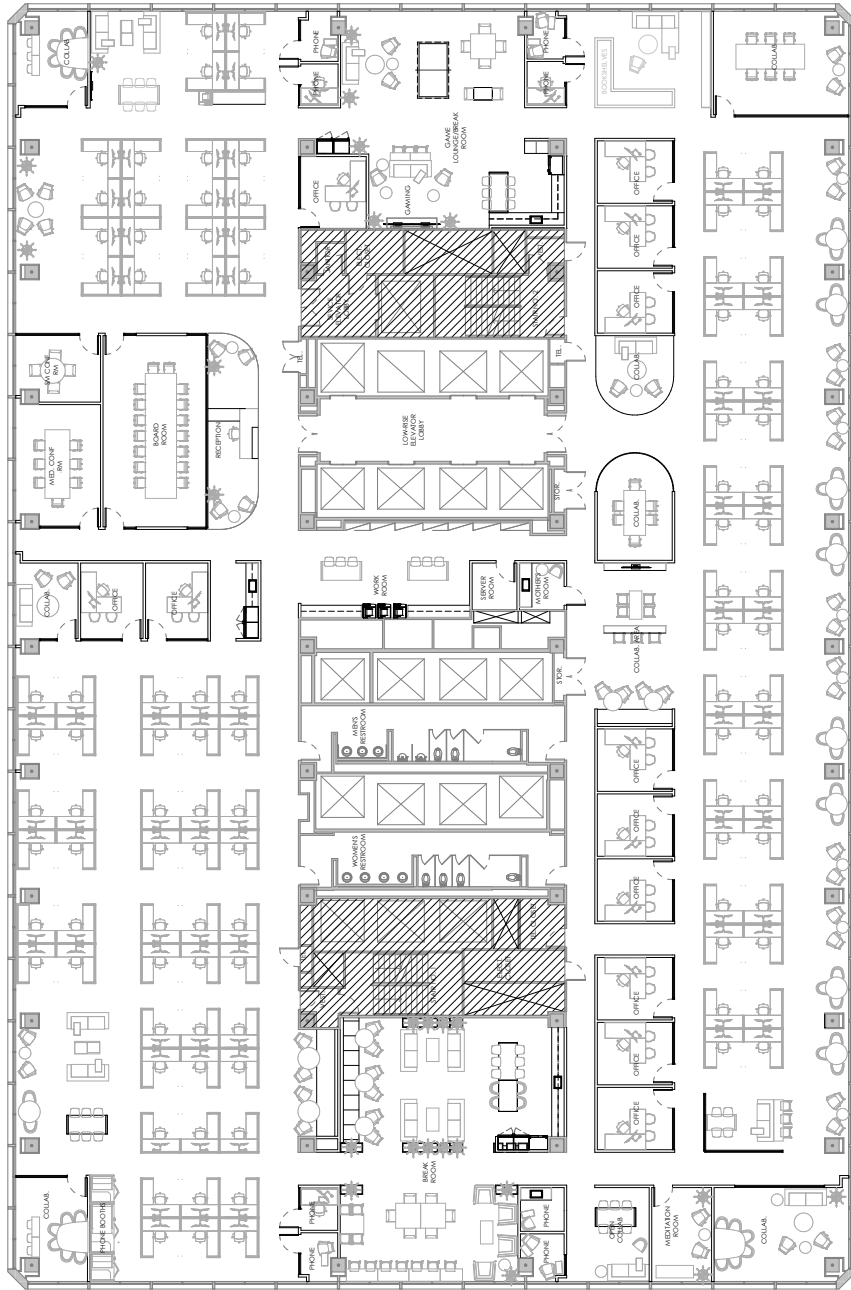

- ± 27,000 RSF
- BOARD ROOM
- (2) CONFERENCE ROOMS
- (9) COLLABORATION ROOMS
- (6) LOUNGE/COLLAB AREAS
- (11) PHONE BOOTHS
- (1) MOTHER'S ROOM
- (117) WORKSTATIONS
- (12) OFFICES
- BREAK ROOM/CAFE
- COFFEE BAR
- READING ROOM
- MEDITATION ROOM

TYPICAL FLOOR PLATE

27,500 RSF

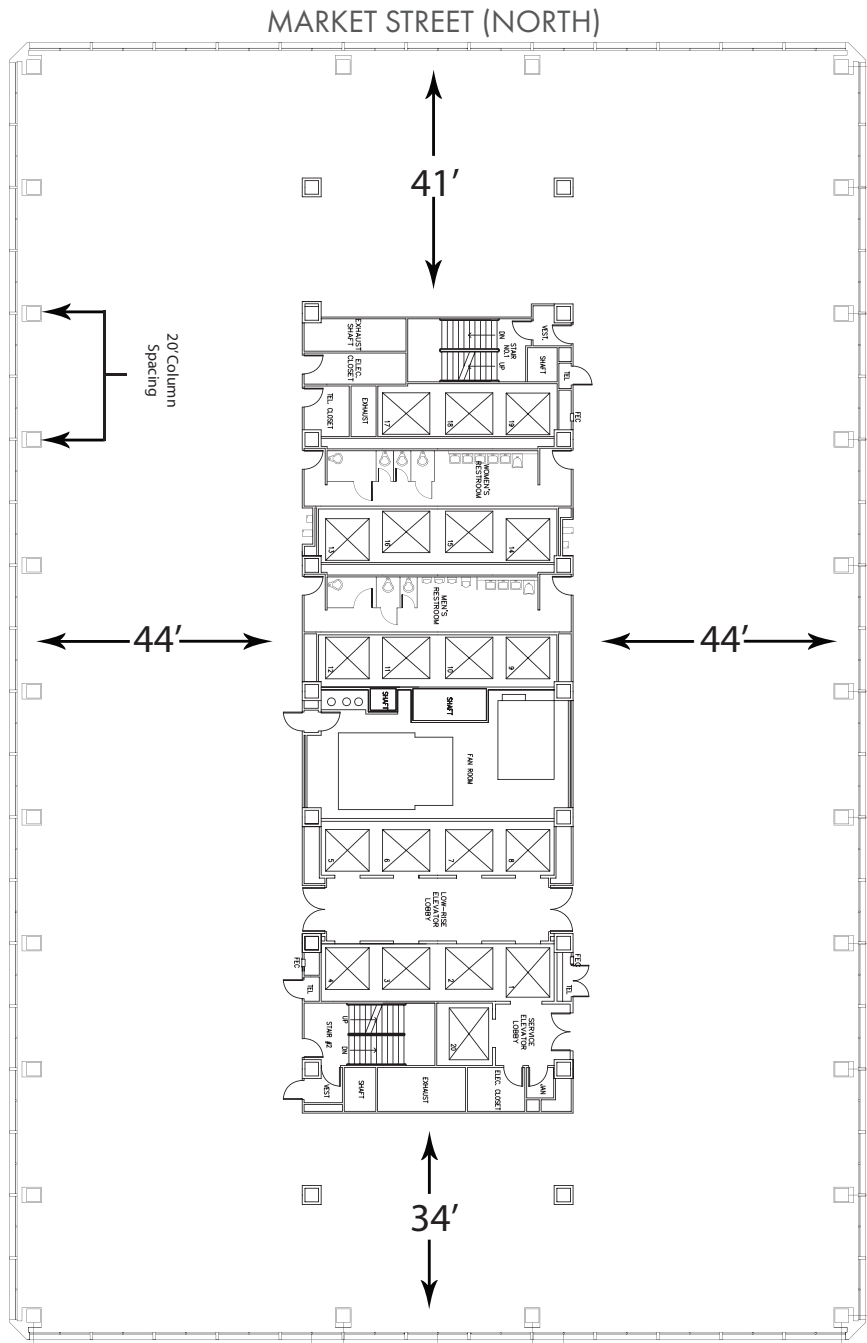

- ± 27,500 RSF
- GENEROUS BAY DEPTHS
- 5' MULLION SPACING
- VIRTUALLY COLUMN-FREE
- RESTROOMS ACCESSIBLE FROM BOTH SIDES
- 8'11" DROP CEILING HEIGHT, 13'8" TO SLAB
- UNDER-FLOOR TRENCH SYSTEM
- WORKS WELL FOR EXPOSED CEILINGS

LOCATION HIGHLIGHTS



Located in the center of downtown San Francisco



Two blocks from the Ferry Terminal



Immediate access to BART & MUNI



On-site parking



1 block to Salesforce Transit Center



Close proximity to restaurants & retail

425
MARKET

425

MARKET
SAN FRANCISCO, CA

FOR MORE INFO, CONTACT:

ZACH SIEGEL

+1 415 773 3596

zach.siegel@cushwake.com

LIC #01129196

SAM WASSERSTEIN

+1 415 773 3528

sam.wasserstein@cushwake.com

LIC #01798616

BRENDON KANE

+1 415 677 0466

brendon.kane@cushwake.com

LIC #01884552



©2023 Cushman & Wakefield. All rights reserved. The information contained in this communication is strictly confidential. This information has been obtained from sources believed to be reliable but has not been verified. NO WARRANTY OR REPRESENTATION, EXPRESS OR IMPLIED, IS MADE AS TO THE CONDITION OF THE PROPERTY (OR PROPERTIES) REFERENCED HEREIN OR AS TO THE ACCURACY OR COMPLETENESS OF THE INFORMATION CONTAINED HEREIN, AND SAME IS SUBMITTED SUBJECT TO ERRORS, OMISSIONS, CHANGE OF PRICE, RENTAL OR OTHER CONDITIONS, WITHDRAWAL WITHOUT NOTICE, AND TO ANY SPECIAL LISTING CONDITIONS IMPOSED BY THE PROPERTY OWNER(S). ANY PROJECTIONS, OPINIONS OR ESTIMATES ARE SUBJECT TO UNCERTAINTY AND DO NOT SIGNIFY CURRENT OR FUTURE PROPERTY PERFORMANCE. COE-PM-WEST- 02/14/23